

# University housing on the Sant Cugat del Vallès ETSAV campus

PUBLISH BY ESPINALT ROMERO | 09 JANUARY 13

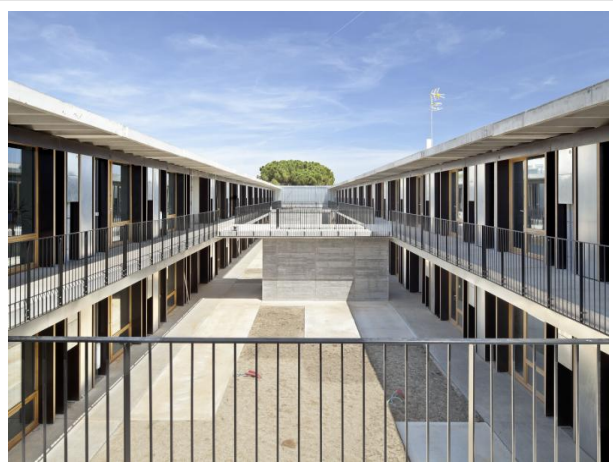

## MINERGIE®

- Project type : New Construction
- Building Type : Student residence
- Construction Year : 2011
- Climate zone : Mediterranean South
- Net Floor Area : 3 101 m<sup>2</sup>
- Construction/refurbishment cost : 2 784 739 €
- Number of Dwelling : 57 Dwelling
- Cost/m<sup>2</sup> : 898 €/m<sup>2</sup>
- Cost/Dwelling : 48 855 €/Dwelling

Calle Pere Serra 1-15 , 08173 Sant Cugat del Vallès  
(Barcelona)  
España

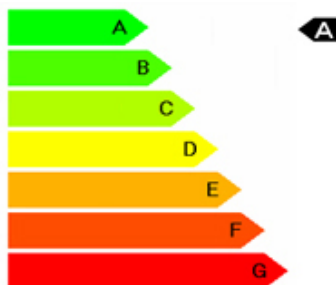

## // Description

Execution of 57 government subsidised homes for the university community of the Vallès School of Architecture (ETSAV). The building, located on the same block as the school of architecture, is set out based on two parallel bars, two storeys high, generating an atrium or central interior patio to be used as a communal space. The building is made up of 62 Compact Habit industrialised modules, 57 of which are dwellings and the rest communal spaces (reception, services, utility rooms, etc.). One of the main aims of the operation was excellence in both sustainability aspects and energy efficiency, obtaining the energy certification "A", in addition to being the first building in Spain to obtain the Swiss certificate "Minergie".

## // Stakeholders

## Designer

---

- H Arquitectes SL y Data AE SL (Roger Tudó y Claudi Aguiló).
- Website : <http://www.dataae.com/ca/> <http://www.harquitectes.com/>

## Developer

---

- Constructora d'Aro SA y Compact Habit SL, Campus Sant Cugat (Jordi Tragant Mestres de la Torre)
- Website : <http://constructoradaro.com/> <http://compacthabit.com/>

## Construction Manager

---

- Constructora d'Aro SA (Jordi Tragant Mestres de la Torre)
- Website : <http://constructoradaro.com/>

## // Energy

### Energy consumption

---

**Primary energy need for standard building** : 91,00 kWh PE/m<sup>2</sup>/year  
**Calculation method** : RD: 47/2007

## // Environment

### GHG emissions

---

**GHG in use** : 54 633,60 KgCO<sub>2</sub>/m<sup>2</sup>/year  
**Methodology used** : CALENER

